

菱王在全球 WINONE GLOBALLY



WINONE 菱王电梯

主要经营：专业生产乘客电梯/观光电梯/载货电梯/自动扶梯及自动人行道等

MAIN BUSINESS: SPECIALIZING IN PRODUCTION OF PASSENGER ELEVATOR/PANORAMIC ELEVATOR/AUTOMATIC ESCALATOR AND MOVING WALK, ETC

地址：佛山市南海区狮山镇狮山科技工业园北园
总机：(0757) 66827888 66827828 66827862
网址：www.winone.cn

Add: North Park, Science and Technology Industrial Park, Shishan Town, Nanhai District, Foshan City,
Guangdong Province, China
Tel: (+86-757) 66827888 66827828 66827862
Web: www.winone.cn



全国服务热线
400-700-7722
SERVICE HOTLINE



微信公共账号

标注：本宣传册为产品推介资料，本公司保留随时更改产品设计和说明的权利，本宣传册中的任何字句，无论其字面意思或含义，对于任何产品及产品的用途和质量，或购销合同条款的表述与更改均不承担任何责任。

Mark: This brochure provides product promotion information, and the company reserves the right to change product design and explanation. Any words this brochure, regardless of their literal meaning or meanings for any product and the usefulness and the quality of the product, purchase and sale of contract clauses statement of changes shall not bear any responsibility.

2017(1)\2017-08



WIN1000 系列载货电梯

WIN1000 SERIES
FREIGHT ELEVATOR

WINONE 菱王电梯股份有限公司
WINONE ELEVATOR CORPORATION LIMITED



WIN1000

系列载货电梯

WIN1000 SERIES

FREIGHT ELEVATOR

Winone elevator

WIN1000

WIN1000 SERIES FREIGHT ELEVATOR

菱王货梯，最值得信赖的运载伙伴

WINONE FREIGHT ELEVATOR, THE MOST TRUSTED CARRIER PARTNERS

菱王WIN1000系列货梯，融合了世界最先进的曳引技术，和成熟可靠的控制驱动系统，性能卓越，用料上乘，结构坚固，超强载重，历久弥坚，安全可靠，是你最值得信赖的运载伙伴。

Winone WIN1000 series freight elevator, integrate the world's most advanced traction technology, mature and reliable driving and control system, excellent performance, large capacity, high quality material, firm structure, safety and reliable which is your most trusted carrier partner.

大载重、高强度，才是硬道理

LARGE CAPACITY, HIGH STRENGTH, IS THE HARD TRUTH

更大载重能力，大开门宽度，可容纳更多货物；高强度的运载性能，更坚固耐用。

A larger load capacity and bigger door open width can contain more goods; high strength delivery performance make the freight elevator stronger and durable.





WIN1000

系列载货电梯

WIN1000 SERIES

FREIGHT ELEVATOR

Winone elevator

WINONE | 运载强劲 安全可靠

CARRY A STRONG SAFE AND RELIABLE

环保节能，引领未来新风向

ENVIRONMENTAL PROTECTION AND ENERGY SAVING, LEADING A NEW FUTURE FASHION

行业领先的新一代永磁同步无齿轮曳引机，彻底降低了电梯的运行成本，达到节约能源、节约空间的要求。创造性地将能源回馈技术应用于电梯领域，将电梯运行中的势能有效转化为电能回馈电网，极大地减少了对电源的谐波污染，实现了能源的再生利用。

Industry-leading new generation permanent magnet synchronous gearless traction machine, completely reduce running cost of the elevator, achieve energy saving, space saving, etc environmental requirements; The creative use of energy feedback technology is applied in the elevator, the elevator energy turn into the electricity, greatly reduces the harmonic pollution to the power supply, realizes the utilization of renewable energy.

跟传统的制动电阻相比，菱王电梯能源回馈系统具有节能、高效的特点。 Compared with the traditional braking resistor, Winone elevator energy feedback system has the characteristics of energy saving, high efficiency.

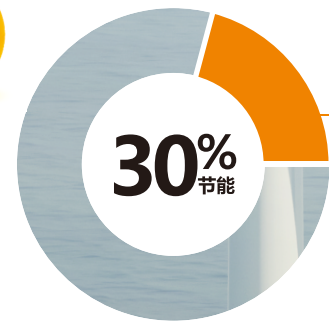

永磁同步无齿轮主机
能源回馈系统

SPM Gearless Machine + Energy Feedback System



循环利用资源
RECYCLING USE OF RESOURCES



低碳排放
LOW CARBON EMISSION



生态环境保护
THE PROTECTION OF THE ECOLOGICAL ENVIRONMENT

跟传统的制动电阻相比，菱王电梯能源回馈系统具有节能、高效的特点。 Compared with the traditional braking resistor, WINONE elevator energy feedback system has the characteristics of energy saving, high efficiency.

菱王创新科技，安全优先考量

WINONE INNOVATIVE TECHNOLOGY, SECURITY CONSIDER TO BE PRIORITY

菱王电梯的远程监控系统、精确的位置控制系统、灵敏的地震检测功能、微机群控系统，所有创新科技的应用都体现了菱王电梯安全优先考量的原则，每一处细节都体现我们对客户的贴心关怀。（此项为选配功能）

Winone elevator remote monitoring system, accurate position control system, sensitive earthquake testing function, microcomputer control system, the application of all technological innovation embodies winone elevator safety priority principle. Every detail is our intimate care.(This function is optional)

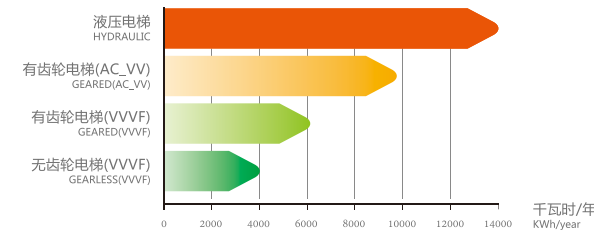
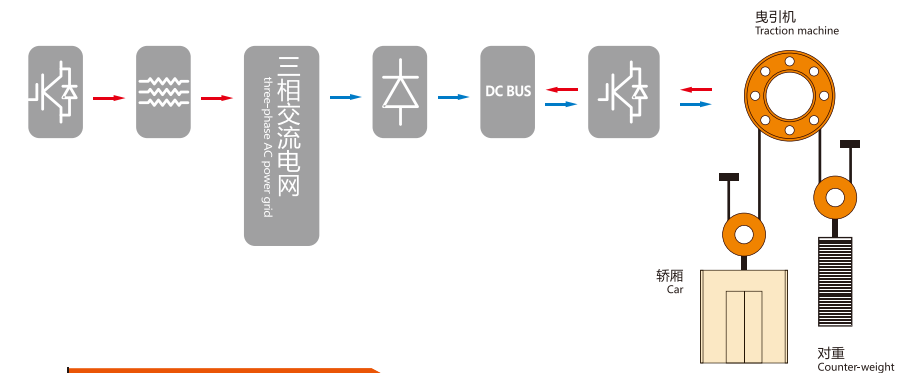

不同产品的能量消耗对比
Different product energy consumption comparison

能源回馈系统工作简图
(该功能为选配功能)
working diagram of energy feedback system
(optional function)



WIN1000

系列载货电梯

WIN1000 SERIES

FREIGHT ELEVATOR

Winone elevator

控制一步到位

控制柜 (32位) 及各候梯厅的呼梯按钮、楼层显示器、厅灯之间采用串行通讯方式。

根据数据内容和量的多少, 分别采用智能协议和算法, 实现了数据通讯的高速大容量化, 因此监视各电梯运转状况和指令的能力, 在通讯速度、精确度、可靠性方面均有大幅度提高。

通讯方式采用业界先进的“BUS LINE(总线)方式”, 系统抗干扰能力强, 扩展能力强。



轿门防扒开装置

能防止电梯在非开锁区域时轿门被打开而导致乘客坠入井道危险的发生, 进一步保障了电梯乘客的安全。



层门防冲击装置

耐撞击层门系统, 使厅门系统的耐撞击能力得到了进一步加强, 有效防止因撞击层门系统而导致的坠入井道危险的发生, 从而进一步保障了电梯相关人员的安全。



UCMP轿厢意外移动保护装置

轿厢意外移动保护装置 (UCMP) 能在电梯厅、轿门处于未关闭状态下防止或制停轿厢从层站意外移动, 从而防止人员伤害及设备损坏的情况发生。

安全性再次升级

率先采用多重电梯保护, 使安全性进一步提升, 最大程度保障了乘客安全, 充分体现了菱王的设计理念。

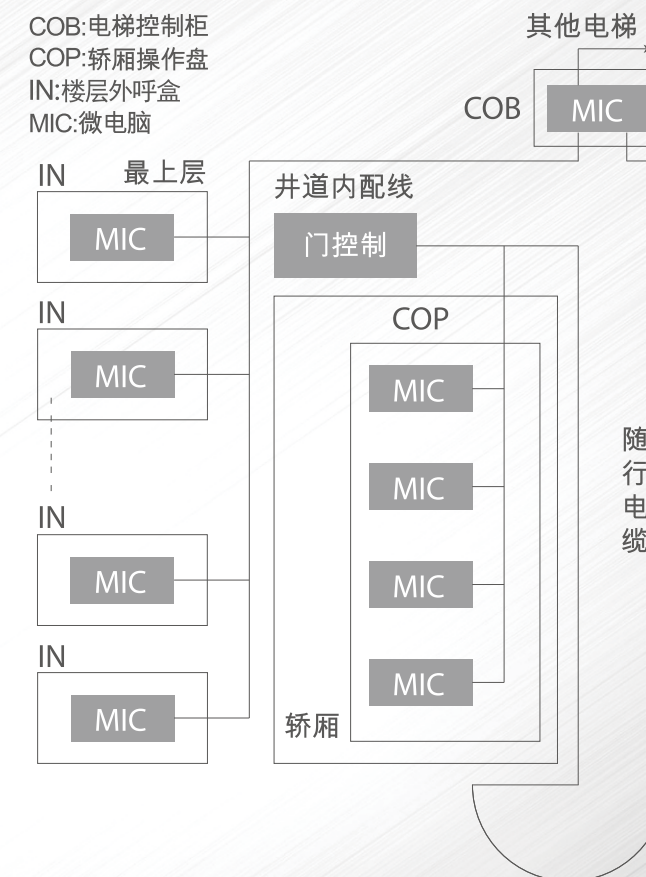

备注: 传统的电梯指令, 是从机房的控制柜通过随行电缆传送到各装置, [分散控制系统]更好的发挥出它的安全性优势, 可依靠所得到的正确指令, 严格地执行各自的功能, 故电梯可获得绝对的安全保障。



WIN1000

系列载货电梯

WIN1000 SERIES

FREIGHT ELEVATOR

Winone elevator



- 物联网+是国家重点发展的战略性新兴产业。
- 电梯物联网是电梯融入智能楼宇、智慧城市的必由之路。
- 电梯物联网是由卖电梯模式向卖服务模式转变的助推器。

物联网监控功能

多梯监控

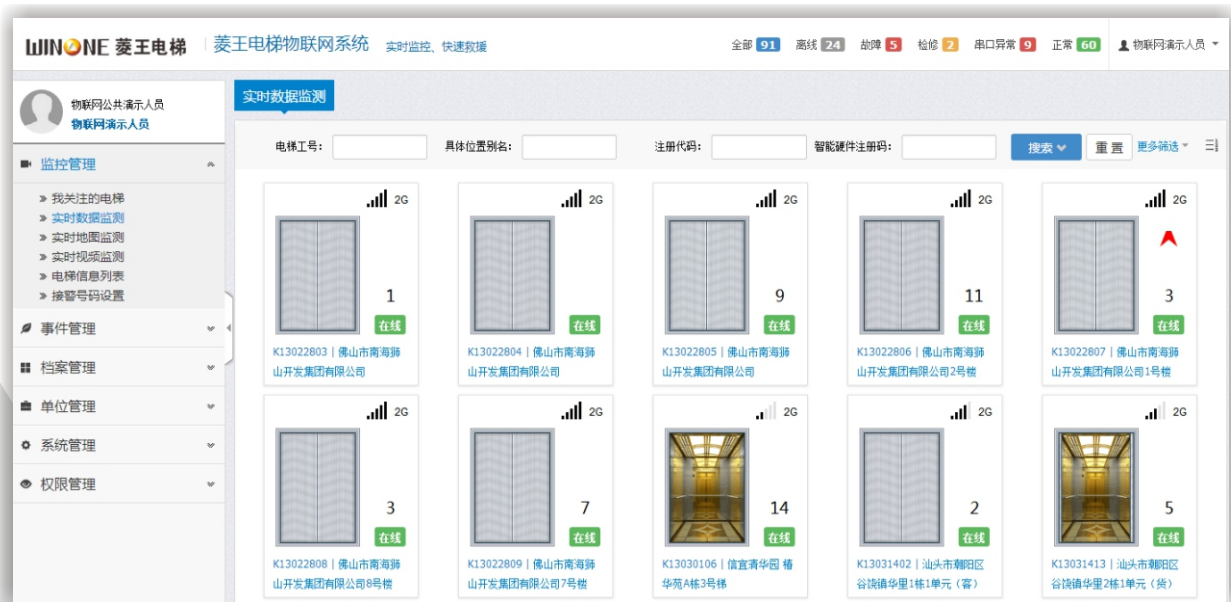

实时监控

电梯的运行状态实时监控。用户、维保单位、制造厂家和监管部门可在第一时间实时查看远处异地的电梯运行状态，保姆式的监控电梯工作。

主动报警

电梯发生故障时，通过移动通信方式及时主动通知维保人员电梯发生的故障信息，维保单位和人员可以及时高效的针对电梯故障进行快速处置。

多重报警

通过物联网设置多个紧急救援电话并依次进行拨号呼叫。

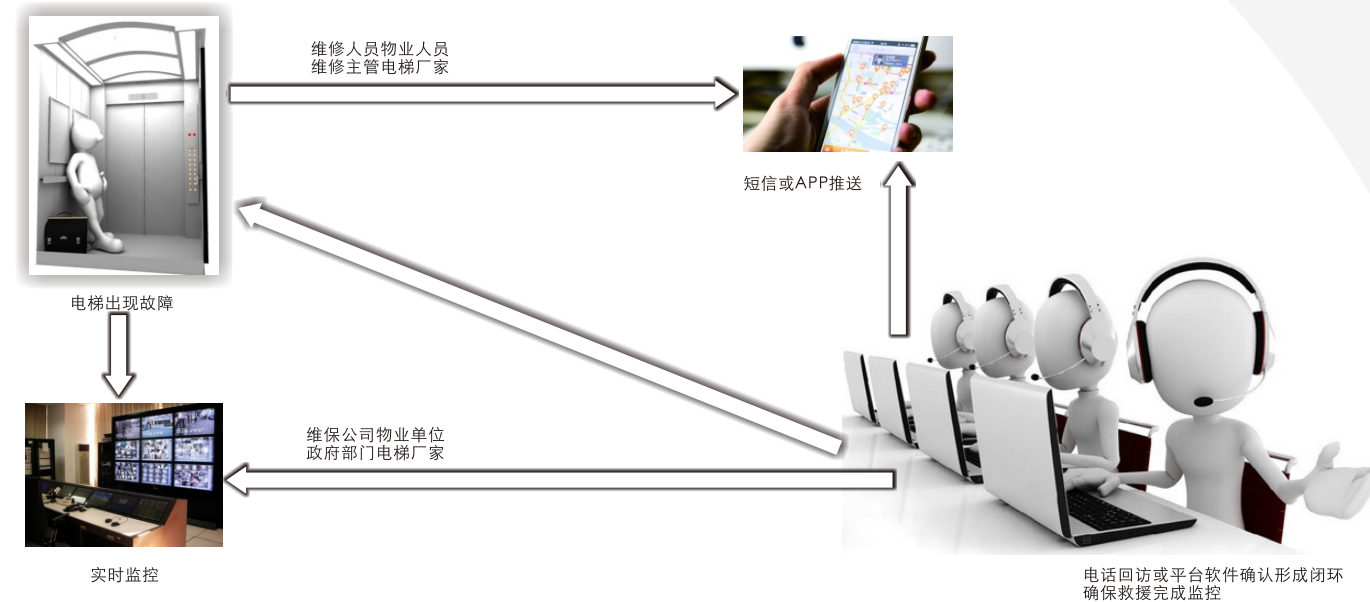

故障定位

利用实时地图，快速定位故障电梯位置，让就近人员及时赶到故障电梯现场进行快速处置。

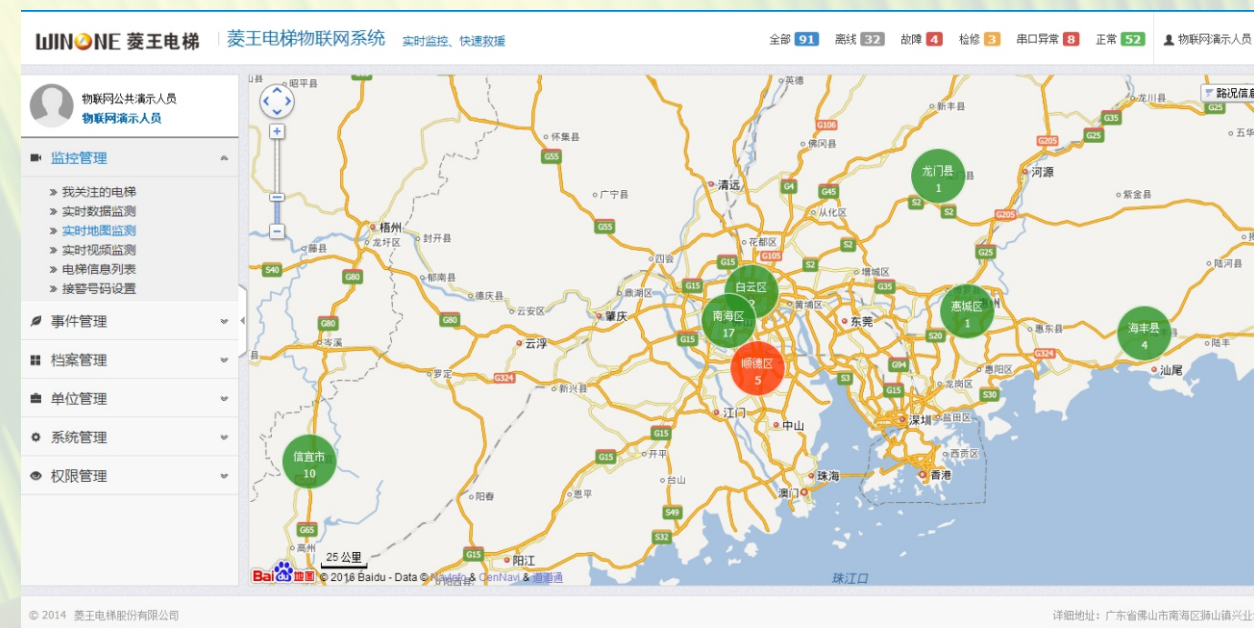

维保监督

有效监管电梯的维保工作，让电梯的维保作业不走形式、过场，提供电梯的维保质量。



WIN1000

系列载货电梯

WIN1000 SERIES

FREIGHT ELEVATOR

Winone elevator

WINONE | 运载强劲 安全可靠

CARRY A STRONG
SAFE AND RELIABLE

小机房、无机房电梯，开启节能、节材新时代

MINI MACHINE ROOM AND MACHINE ROOMLESS, OPEN A NEW ERA OF ENERGY AND MATERIAL SAVING

菱王小机房/无机房载货电梯，提升了电梯的运行效率，使电梯变得更轻巧环保，从而为您节省宝贵的建筑空间及节约电能。

Winone Mini Machine Room Freight Elevators, improve the running efficiency of the elevator, become smaller and environment protection, so as to save your valuable building space and energy.

永磁同步无齿轮小机房、无机房电梯，比传统异步有齿轮式电梯节约30%的能耗。

Compared with the Asynchronism gear Elevator, SPM (Synchronous Permanent Magnetic) Gearless Mini Machine Room and Machine Roomless Elevator can save around 30% energy.

永磁同步无齿轮小机房、无机房电梯，比传统异步有齿轮式电梯提高25%~30%的传动效率。

Compared with the Asynchronism gear Elevator, SPM (Synchronous Permanent Magnetic) Gearless Mini Machine Room and Machine Roomless Elevator has improved 25% to 30% transmission efficiency.

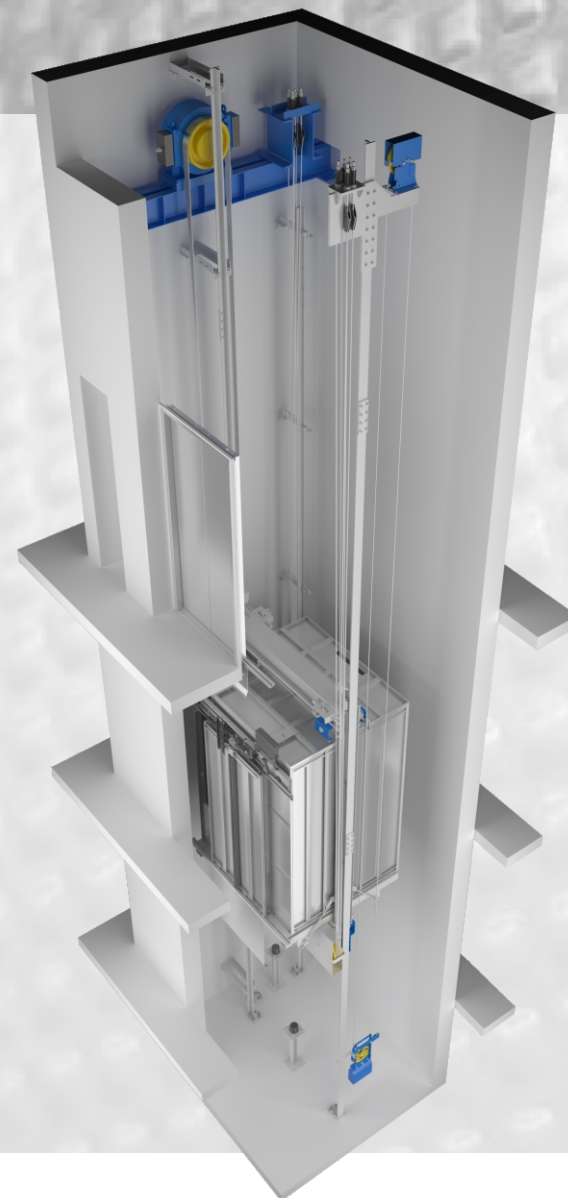

噪音低
Low noise



绿色环保
Green environmental protection



高效节能
High efficiency and energy saving



节省空间
Save space



稳定可靠
Stable and reliable

节约建筑成本

SAVE THE BUILDING COST

菱王无机房载货电梯省去机房空间面积，使您更有效地利用建筑空间。它能节约建筑时间、材料和成本。

Winone Machine Roomless Freight Elevators can save space of the machine room, to use the architectural space effectively. It can also save construction time, material and cost.

MACHINE ROOMLESS FREIGHT ELEVATOR

< 无机房载货电梯

便捷安装 提高效率

CONVENIENT INSTALLATION TO IMPROVE EFFICIENCY

菱王小机房载货电梯结构紧凑、轻盈小巧，安装方便，维护便捷，能大大节省空间，提高安装效率。

Winone Mini Machine Room Freight Elevator structure is compact, light, easy installation and convenient maintenance, can save space greatly and improve the efficiency of installation.

MINI MACHINE ROOM FREIGHT ELEVATOR

小机房载货电梯 >

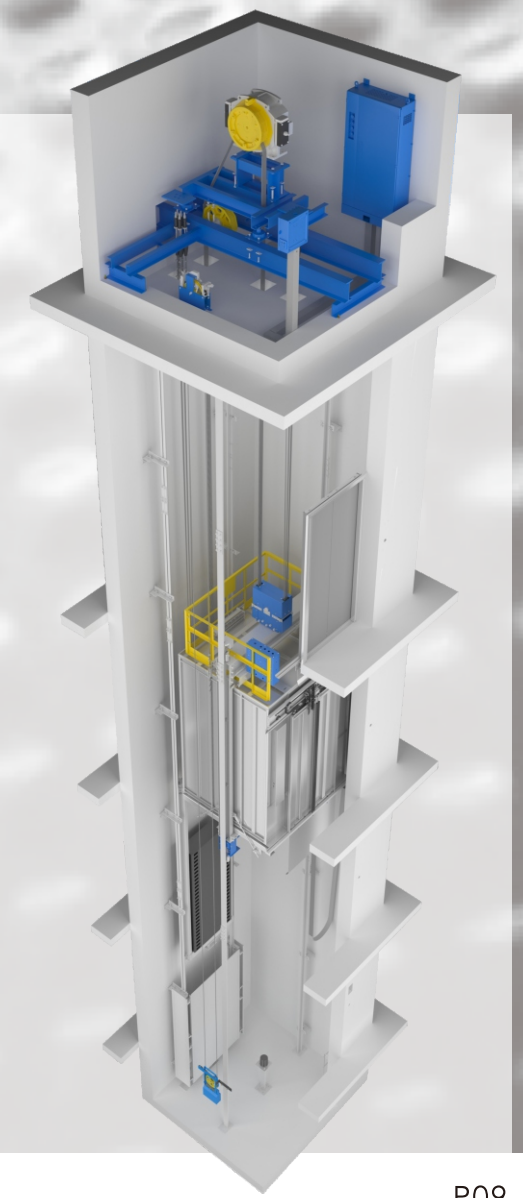



WIN1000

系列载货电梯

WIN1000 SERIES

FREIGHT ELEVATOR

Winone elevator



轿厢 CAR

空间宽敞明亮，给您提供更强劲的运载感受。
Space is capacious, bright, stronger loading ability

轿顶装潢 CAR CEILING 一体式吊顶、LED照明
INTEGRATED CEILING, LED LIGHTING

轿壁装潢 CAR WALL 喷塑钢板
PAINTED STEEL

轿底装潢 CAR FLOOR 花纹钢板
PATEN STEEL FLOOR



运载强劲 安全可靠

CARRY A STRONG SAFE AND RELIABLE

操控箱/外呼盒 CAR OPERATION PANEL/ HALL CALL BUTTON

WINONE系列电梯操纵箱、外呼盒，造型简约，极富现代感，轻触式的按钮，操作方便自如。楼层及方向采用点阵显示器，并可根据用户的要求显示特殊的数字。

WINONE series elevator of control operation panel and hall call panel are simple and modern. Light touch button makes easy operation. High brightness LED digital display are used for floors and direction. Special number can be display according to users' requirements.

材质 MATERIAL 发纹不锈钢
HAIRLINE STAINLESS STEEL

显示 DISPLAY COP白光点阵；LOP白光点阵
COP WHITE DOT MATRIX; LOP WHITE DOT MATRIX

按钮 BUTTON 发纹不锈钢；凸字；带盲文；白光
HAIRLINE STAINLESS STEEL, WITH BRAILLE, WHITE LIGHT

层门款式 LANDING DOOR

层门、门套的装潢、色彩和材料品种繁多，多种组合可供选择，确保电梯设计与大楼环境统一。

Various Finishes, Color And Material Of Landing Hall Door And Landing Hall Door Jamb, Multi Combination For Choosing, To Ensure Elevator Design And The Building Matching.

< C1310A-F

L1311A-F >

门套 DOOR JAMB 喷塑钢板
PAINTED STEEL

层门 LANDING DOOR 喷塑钢板
PAINTED STEEL



备注：由于印刷的原因可能与实物出现色差，以工厂样品为准。
Remark: As printing, the real colour maybe different., Prevail in kind.



WIN1000

系列载货电梯

WIN1000 SERIES

FREIGHT ELEVATOR

Winone elevator

标配功能表 STANDARD FUNCTION

安全保护功能 Security function

01	门区外不能开门保护 Door can't open beyond door zone	为安全起见，在门区外，系统设定不能开门。 For security, elevator door can't open if cabin is not in door zone.
02	门光幕保护 Infrared light curtain protection	当两扇轿门的中间有物体阻挡时，光幕保护动作，电梯就会开门。 When there is something block between doors, infrared will activate then doors open.
03	超载保护 Over load protection	当电梯承载的重量超过所规定的重量时超载动作，电梯不关门，不能运行且蜂鸣器响。 When overload, elevator doors don't close and buzzer rings.
04	逆向运行保护 Reversal running protection	检测电梯规定时间内运行方向与指令方向不一致时，立即停车故障报警。 When inspect the reverse running direction to the running order, elevator will stop and comes error record.
05	卡阻保护 Blocking protection	自动状态下。电梯连续运行规定时间后，没有平层开关动作，电梯就会报卡阻保护。 In automatic state. After the continuous operation of the elevator for a specified time, there is no flat switch action, the elevator will be reported blocking protection.
06	终端越程故障保护 Terminal over run protection	电梯上下终端都装有保护开关(减速、限位及极限)，以保证电梯不会超越行程。 To ensure elevator won't over run, there are terminal switches both in upper part and lower part of the shaft.
07	相序保护 Phase protection	当供电电源发生断相、缺相和错相时，停止电梯运行。 Elevator will stop running when detect wrong phase and missing phase.
08	安全接触器触点粘连保护 Contactor protection	检测触点(安全触点接触器触点)和线圈的驱动状态不一致时，停止电梯一切运行。 When detect the difference between contactor and coil, elevator will stop.
09	井道自学习失败诊断 Failure analysis of shaft study	井道自学习未能正确完成时设置了井道自学习失败诊断。 When shaft study doesn't finish, system will analysis the failure reason.
10	曳引机温度保护 Traction machine temperature protection	为防止曳引机过热导致运行危险而设置的保护功能。 To prevent the traction machine overheating caused by the risk of running the protection function
11	门开关故障保护 Door opening failure protection	系统检测门系统上开关状态，发现异常时停止电梯继续运行，防止事故发生。 When system detect the door lock failure, it will stop the elevator to prevent accident happens.
12	门锁短路故障保护 Protection for door lock bridge	在电梯开门到位后，若系统检测到门锁接触器接通，则故障报警，并取消运行。 When door fully open, if the system detect problems with the door contactor, elevator will stop.
13	运行中门锁断开保护 Protection for door lock break when running	运行中如果电梯的任何一个门锁发生断开现象，电梯就会急停保护。 The elevator stop running if the door lock suddenly break.
14	超速保护 Over speed protection	为防止速度超出控制范围的运行导致的安全问题，实施此保护。 When over speed, elevator will stop running.
15	抱闸开关触点检测保护 Protection for brake contactor	系统检测抱闸是否可靠动作，发现抱闸不能可靠动作，则进行保护动作。 If system detect the brake active is not reliable, it will start the protection.
16	盘车安全保护功能 Wheeling protection	在进行盘车操作时禁止电梯运行。 During the wheeling operation stop the elevator function.
17	平层开关故障保护 Leveling switch protection	为了防止平层开关发生故障引起电梯异常情况而采取的一种安全保护。 A protection to prevent failure occurs when leveling.
18	CAN通讯故障保护 CAN communication protection	当CAN通讯发生故障时防止继续运行导致危险。 Stop running when CAN communication error occurs.
19	主回路故障保护 Main circuit protection	系统检测到主回路故障信号时就紧急停车，并在有故障时停止电梯运行。 In case of main circuit comes out problems.
20	主控CPU WDT保护 Main CPU WDT protection	当检测到CPU WDT故障或程序故障时，WDT回路强行断开主控制器输出，并使CPU复位。 When detect CPU WDT failure, WDT circuit will stop the output and reset the CPU.

WINONE | 运载强劲 安全可靠

CARRY A STRONG SAFE AND RELIABLE

运行控制功能 Running control function

1	全集选控制 Full collective control	在响应运行指令的同时，任何楼层或轿厢内的乘客都可召唤电梯。 When the elevator responds to order, Passenger from the cabin or floor can call the elevator.
2	检修运行 Inspection operation	当符合运行条件，按上/下行按钮可使电梯以检修速度点动向上/下运行。 When in Inspection, push UP/DN button can drive the elevator accordingly in low speed.
3	慢速自救运行 Low speed running	电梯处于正常状态下，且不在门区，此时只要符合起动的安全要求，电梯将自动以慢速运行至平层，开门放客。 In Normal condition and cabin not in door zone, elevator will move to the closest floor and open door to let people go out.
4	到站自动开门 Automatic door open when arrive	电梯在自动状态下，到了指令楼层或外召楼层后会自动开门。 Elevator will open the door automatically when reach the required floor.
5	保持开门时间的自动控制 Controllable door opening time	在自动状态下，电梯到站开门后，延时若干时间后自动关门。 When in normal mode, door will open automatically, then close in a certain of time.
6	本层厅外开门 Door open button (hall call panel)	本层召唤按钮被按下，电梯门自动打开，召唤按钮按住不放，门保持打开。 Door remain opening when the OPEN button is pressed.
7	关门按钮提前关门 Door pre closing function	在自动及保持开门的状态下，可以按关门按钮使门立即响应关门动作。 Close the door when CLOSE button is pressed.
8	开门按钮开门 Door open button (car operation panel)	电梯停在门区时，在轿厢内按开门按钮使已经关闭或尚未关闭的门打开。 When the cabin is in door zone, press OPEN makes the door open again.
9	轿内照明风扇自动节能 Automatic turn off lighting and fan	电梯无指令和外召登记超过规定时间(3分钟)，轿内照明、风扇自动断电。 When there is no calling for more than 3 minutes, system will close the fan the lighting in the cabin.
10	自动返基站 Automatic return home floor	自动状态下，当无指令和召唤时，电梯在一定时间延时后自动返回基站。 In Normal condition, elevator retrun to home floor when there is no calls or indications.
11	重复关门 Door reclosing	在门机系统的偶然性故障或异物卡在门中间导致的停梯故障时，尝试再次关门。 When there is block in the door zone and cause the door close error, system will try to close the door again.
12	故障历史记录 Error recording	可记录10条以上最近的故障。 Main board can record the recent 10 errors at most.
13	井道层楼数据自动学习 Shaft self study	电梯正式运行前，学习井道内各种数据(层高、开关等)，并永远保存这些数据。 Elevator can learn the shaft data and situation automatically efore using.
14	司机操作 Attendant service	司机操作时，电梯关门时司机持续按关门按钮条件下进行，只响应轿内指令。 Elevator only responds to the order from the cabin when attendant service is on.
15	直驶操作 Bypass operation	在司机情况下，按直驶开关，电梯直接运行到轿内的指令层，不响应外呼召唤。 When elevator in attendant mode, press the BYPASS button, elevator will run directly to the required floor without getting any call outside.
16	自动修正楼层位置信号 Automatic correct floor position signal	系统运行到终端和平层开关点时，对电梯位置信号以自学习位置数据进行修正。 Correcting the data when the elevator reach final limit switch.
17	锁梯服务 Elevator locking	自动状态下，锁梯开关有效后，电梯响应完所有召唤登记并返回基站，自动关门后关闭轿内照明和风扇，而后停止运行。 After locking, elevator will finish all the calling and return to home floor, then turn off the fan and light.
18	双门控制 Double door control	此功能用于贯通门控制(轿厢双门时有效)。 This is for open through door only.
19	独立运行 Independent running	电梯不接受外召登记，也没有自动关门，其操作方式同司机直接操作类似。 Elevator doesn't reponse to any outside call and there isn't automatic door close, other function similar to attendant function.
20	强迫关门 Force door closing	如果光幕动作或其他原因使电梯连续规定时间内开着门而没有关门信号，电梯就强迫关门并发出强迫关门信号。 If light curtain activate or other cause keep the door opening for a certain of time, system will force the door close.
21	服务层的任意设置 Randomly set up service floor	通过操作器可以任意设置电梯停靠哪些层站，哪些层站不停靠。 Through control pad can define the service floor.
22	自动平层 Automatically parallel	根据乘客的指令，轿厢准确停靠在对应的楼层。 According to the passenger's instructions, the car is accurately docked at the corresponding floor.



WIN1000

系列载货电梯

WIN1000 SERIES

FREIGHT ELEVATOR

Winone elevator

运行控制功能 Running control function

22	测试运行 Test running	用于测试或考核新梯用,以检测新梯是否正常运行。 To test whether the new elevator works or not.
23	时钟控制 Clock control	系统内部有实时的时钟,因此故障发生时可记录确切的时间。另外,可用时钟控制的方式确定电梯停靠哪些楼层。 To record the time of errors occurs, and also set up the time when the elevator stop running.
24	直接停靠 Direct landing	电梯按照距离原则运行及减速,平时时无任何爬行,可提高电梯的运行效率。 According to distance principle, there will be no creeping when leveling, improve the operation efficiency.
25	称重补偿 Weight compensation	控制系统自动检测到轿厢载荷数据,加载补偿值,以改善电梯起动的舒适感。 System detect the weight data and calculate the compensation to keep elevator run smoothly.

应急及纠错功能 Emergency and Error Correction Function

1	对讲机通讯 Interphone communication	电梯的机房、轿顶、轿厢、底坑及值班室的对讲通讯。 Elevator room, car top, car, pit and duty room intercom communication.
2	警铃功能 Alarm bell	当电梯发生异常时,可以在轿厢通知外面的一种报警方式。 When the elevator is abnormal, you can notify the outside of the car in a way of alarm.
3	停电应急照明 Emergency lighting	当电梯停电后为轿厢提供应急照明及报警电源。 When the elevator power failure for the car to provide emergency lighting and alarm power.
4	错误指令取消 False call canceling	乘客按错指令响应后,可在指令登记后连接按2次错误指令的按钮以取消登记。 By double press the floor number button, it can cancel the call.
5	反向时自动消指令 Automatic reversal call canceling	当电梯到达最远层站将要反向时,原来所有反方向登记的指令全部消除。 When the elevator finishes the final calls, it will cancel all the other orders.

显示及提示功能 Display and remain function

1	楼层显示字符设置 Floor display set up	通过操作器可以任意设置每一楼层显示字符(系统所规定的字符) Floor display can be setted up through control pad.
2	点阵式楼层显示器 Dot matrix floor indicator	系统显示采用点阵式楼层显示器,具有字符丰富、显示生动、字形美观等特点。 For cabin operation panel and hall call panel.
3	滚动显示运行方向 Rolling display of running direction	厅外和轿内显示在电梯运行时都采用滚动的方式显示运行的方向。 For cabin operation panel and hall call panel.

WINONE | 运载强劲 安全可靠

CARRY A STRONG SAFE AND RELIABLE

选配功能表 OPTIONAL FUNCTIONS

安全保护功能 Security function

1	地震功能 Earthquake function	当地震检测装置动作,控制系统就会控制电梯即使在运行过程中也会就近停靠。 When the earthquake monitoring device, the control system will control the elevator will even in the running process to the nearest dock.
---	------------------------------------	--

运行控制功能 Running control function

1	提前开门操作 Advance door opening	电梯在平层过程中,当离门区规定距离,且速度小于规定值时,可以提前开门。 When fireman switch activates, all the elevator calls cancel and cabin return to home floor immediately.
2	副操作箱操作 Sub car operation panel control	在有主操纵箱的同时,可装配副操纵箱;副操纵箱和主操纵箱一样,也装有指令按钮和开关门按钮。 Performs like the main car operation panel.
3	后门操纵箱操作 Rear door operation panel	在有主操纵箱的同时,可装配后门操纵箱;后门操纵箱和主操纵箱一样,也装有指令按钮和开关门按钮。可根据用户的需求,控制后门的开关。 In the main control box at the same time, you can assemble the back door control box; the back door control box is the same as the master control box; there are also the command button and the switch button, which can control the back door switch according to the user's needs.
4	前后门独立控制 Separate control for both front and rear door	前后门独立控制有两点:一是指有后门操纵箱时的前后门独立控制;二是指当有后门外呼盒时的前后门独立控制。 Two kinds of this: 1. Separate door control when have rear car operation panel. 2. Separate door control when have rear hall call panel.
5	开关控制群控梯服务 Switches for shift service floor for group control	群控系统预设两组特定条件电梯停层的方案供客户选择,分别通过两个开关控制。方案需要预先设定,它可以指每台电梯在哪些楼层响应指令等一些功能。 Pre-setting service floor can be shifted by switch. The setting can define which floor to stop.
6	开关控制单体服务层切换 Switches for shift service floor for single elevator	预设特定条件电梯停层的方案给客户,通过开关控制。方案需要预先设定,它可以指电梯在哪些楼层响应指令等一些功能。 Pre-setting service floor can be shifted by switch. The setting can define which floor to stop.
7	开门保持按钮操作功能 Door remaining open function	通过按住开门保持按钮,提供使电梯延时关门的一种功能。 By pressing door open button to extent the door open time.
8	货梯和自动智能载货车(AGV)联控 Freight elevators and Automated Guided Vehicle (AGV) joint control	自动智能载货车(AGV)、自动呼梯、自动登记及乘梯。 Automated Guided Vehicle (AGV), Automatic call elevators. Automatic registration and operation.
9	轿门防撞报警保护功能 Car door anti-collision alarm protection function	装载货物时,当货物触发轿内传感器时,将会输出报警声响。 When the goods are loaded, an alarm sound will be output when the goods trigger the in-car sensor.
10	关门倒计时功能 Door closing countdown function	电梯开门到位后,开始倒计时,倒计时到0时,会发出鸣响,电梯关门。 After the elevator opens the door in place, the countdown starts, the countdown time to 0, will be issued a ring, the elevator closed.

应急及纠错功能 Emergency and Error Correction Function

1	停电应急平层 Automatic rescue device	当电梯因停电导致运行中的轿厢停止运行,停电应急平层装置就会启动,轿厢不在开门区时,低速运行停靠就近楼层开门,防止困人。 When the elevator stops running due to the power failure, the power failure emergency leveling device will start. The car is not in the open area, and the car will low speed close the nearest floor and open the door to prevent the trapped people.
2	消防紧急返回操作 Emergency return in case of fire	当消防开关动作后,电梯立即消除所有指令和召唤,以最快的方式运行到消防基站后,开门停梯。 When fire alarm activate, system will cancel all the call and return to home floor, then elevator stop.

显示及提示功能 Display and remain function

1	电梯物联网 Elevator networking	利用现代物联网技术及高科技手段建立的电梯远程监测系统。 The use of modern Internet technology and high-tech means to establish the elevator remote monitoring system.
---	-------------------------------------	--

CONSTRUCTION LAYOUT

小机房载货电梯土建布置图

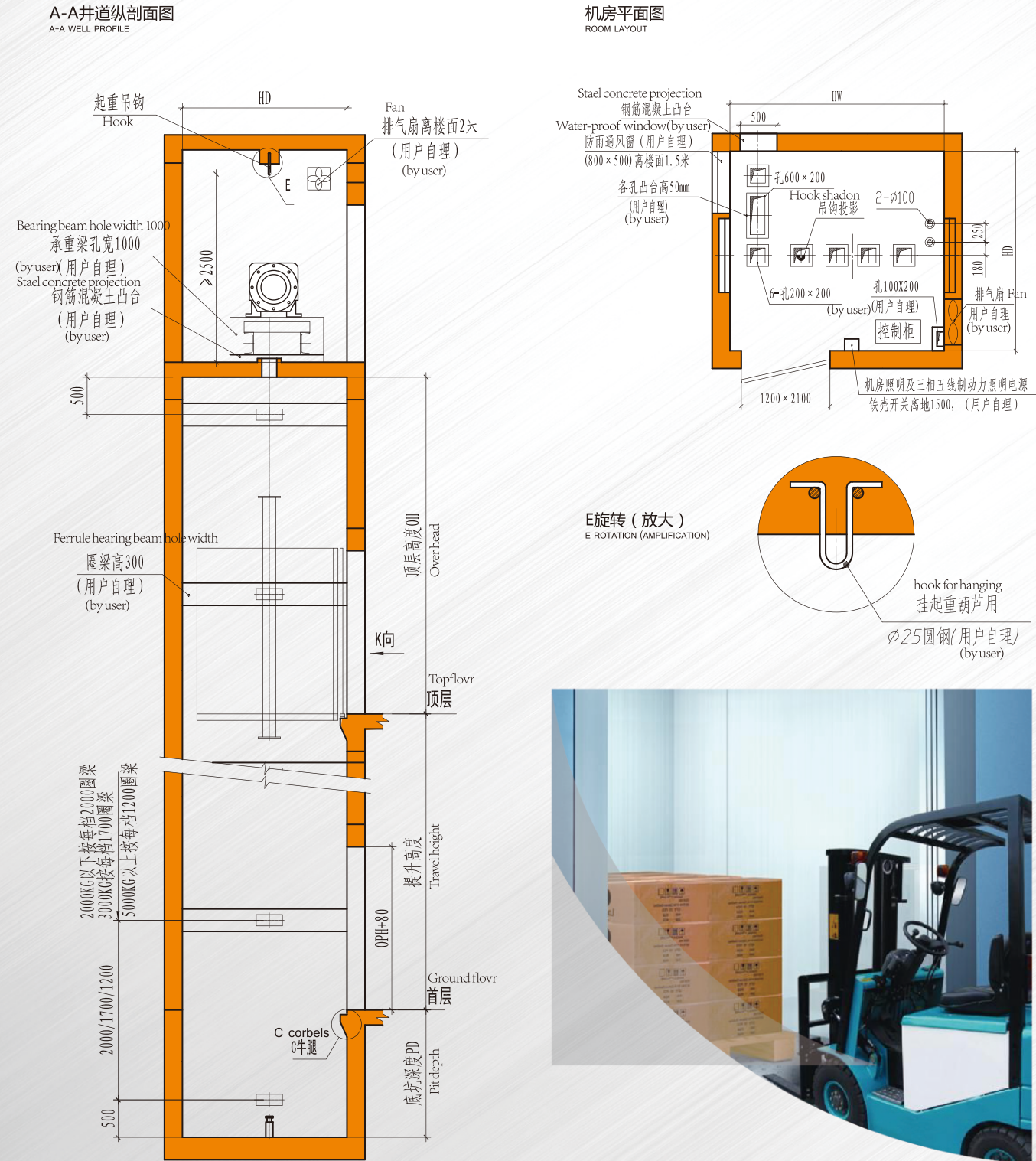

井道平面图
BOTTOM PLANE GRAPH

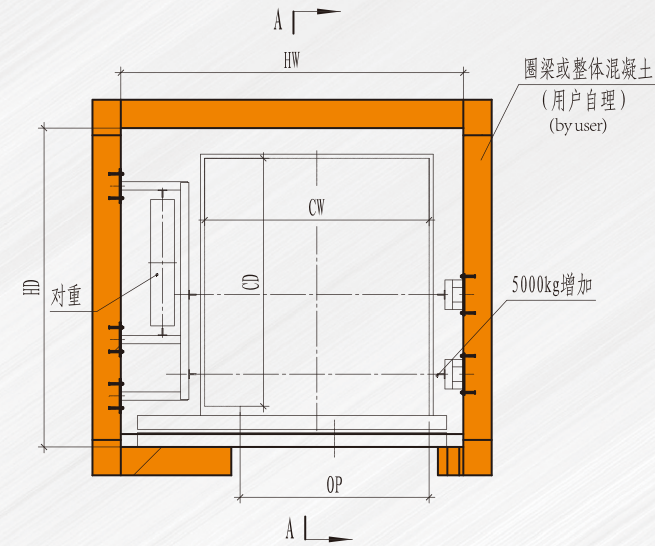

C牛腿 (放大)
C CORBELS (AMPLIFICATION)

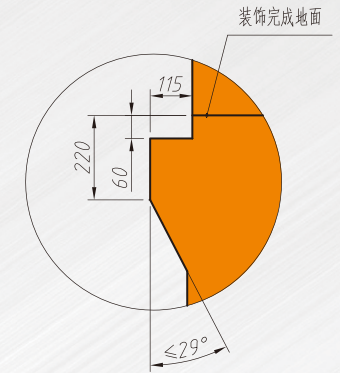

K向厅门立面图
K TO THE HALL DOOR ELEVATION

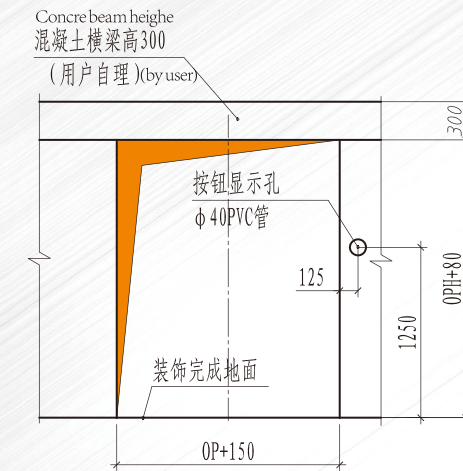

底坑平面图
PIT FLOOR PLAN

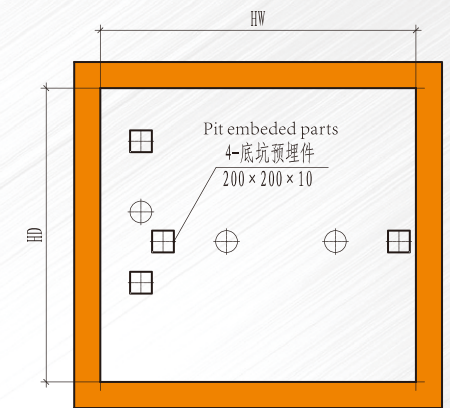

WIN1000-IV 系列载货电梯技术参数 (4:1永磁同步)
WIN1000-IV SERIES FREIGHT ELEVATOR TECHNOLOGY PARAMETERS

型号 MODEL	载重量 (kg) CAPACITY (kg)	速度 (m/s) SPEED (m/s)	轿厢净尺寸 (宽×深×高, mm) NET CAR SIZE (CW×CD×CH, mm)	井道净尺寸 (宽×深, mm) NET OPENING (OP×OPH, mm)	净开门 (宽×高, mm) NET WELL SIZE (HW×HD, mm)	高度 OH (mm) OH (mm)	底坑深度 PD (mm) PD (mm)	额定功率 (KW) RATED POWER (kW)
LTHX2000	2000	0.5/0.75/1.0	1900×2100×2200	2900×2700	旁开1600×2100	4300	1500	6.6/11.6/13.6
LTHX3000	3000	0.5/0.75/1.0	2200×2500×2200	3300×3200	旁开1700×2100	4300	1600	11.1/19.4/22.2
LTHX5000	5000	0.5/0.75/1.0	2800×3100×2200	4200×3800	中分四扇2400×2100	4500	1800	17/27.2/37
LTHX6000	6000	0.5	2800×3700×2200	4500×4300	中分四扇2600×2100	4500	1900	31.2
LTHX7000	7000	0.5	3000×3900×2200	4700×4800	中分四扇2600×2100	4500	1900	36.4
LTHX8000	8000	0.5	3000×4500×2200	4900×5200	中分四扇2800×2100	4500	1900	41.6

注：此图仅供参考，如须施工用图，请以井道图册或技术部设计为准！
Note: This Table Is For Your Convenience To Choose the Product Only. For actual construction, please refer to the well drawing or the design of the technology department.

CONSTRUCTION LAYOUT

小机房载货电梯土建布置图

A-A井道纵剖面图
SHAFT SECTION A-A

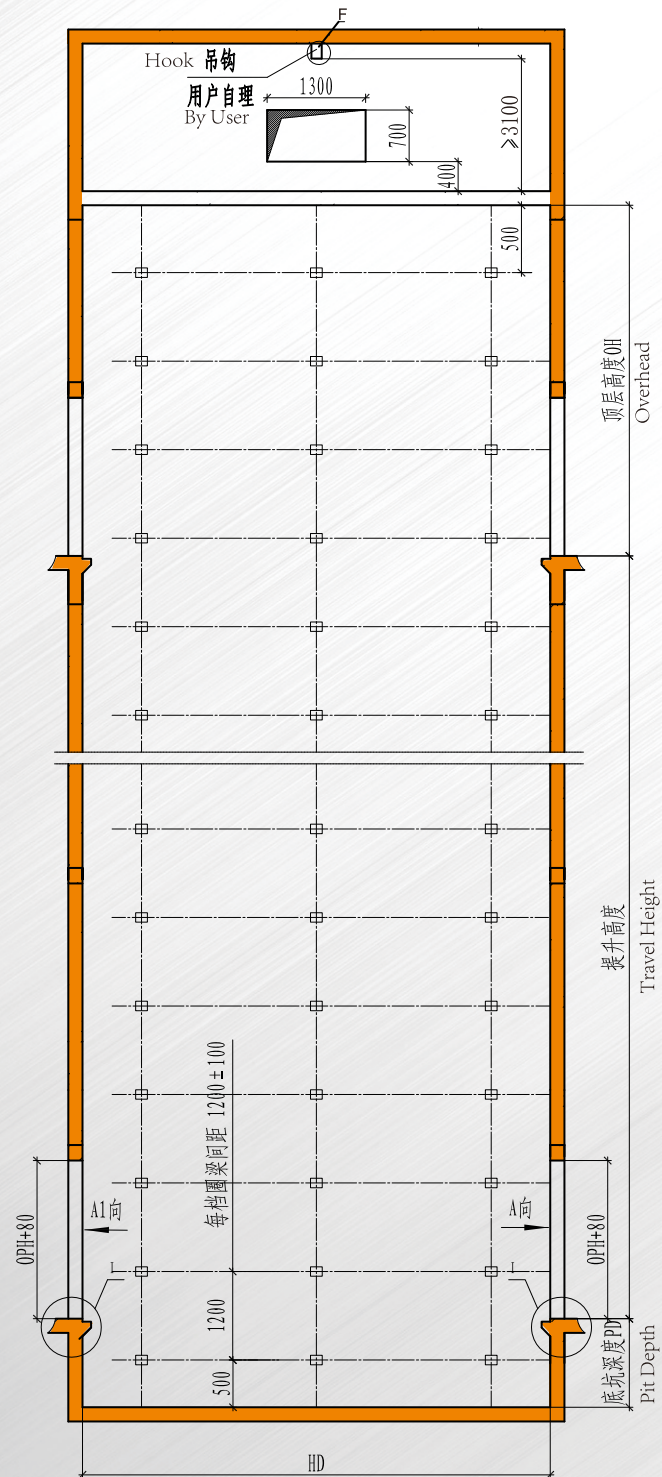

F旋转 (放大)
E ROTATION (AMPLIFICATION)



I (放大)
I (AMPLIFICATION)
1:5

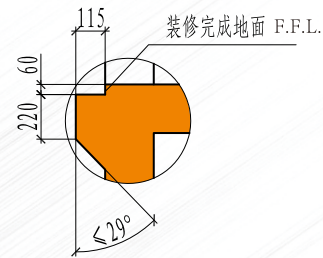

机房开孔型式
BOTTOM PLANE GRAPH

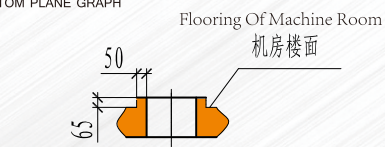

C向
C SIDE

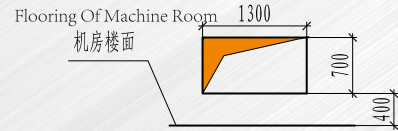

E向
E SIDE



井道平面图
SHAFT PLAN

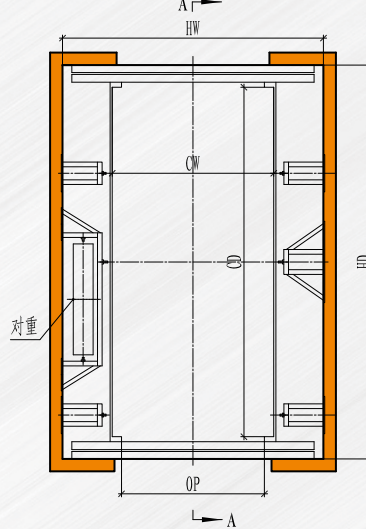

底坑平面图
PIT PLAN

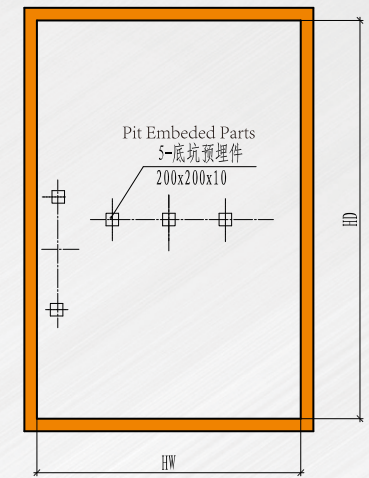

机房平面图
MACHINE ROOM PLAN

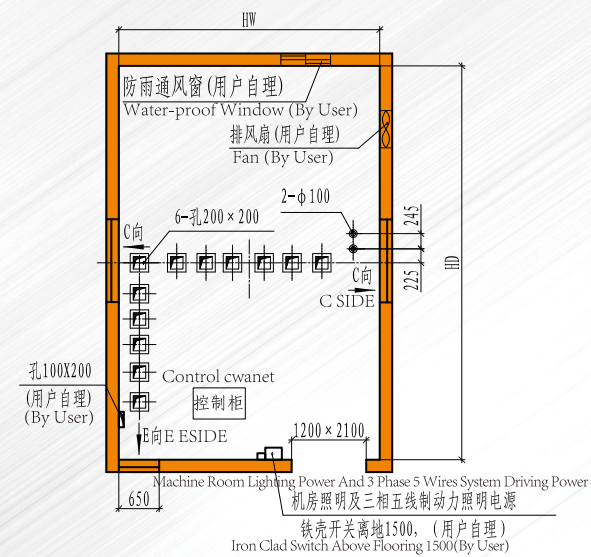

K向厅门立面图
K ESIDE LARDING FLOOR PLAN

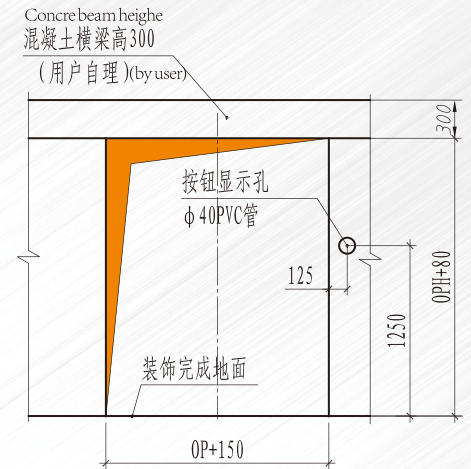

WIN1000-III系列货梯技术参数 (6:1永磁同步)

WIN1000-III ELEVATOR WITH MINI MACHINE ROOM TECHNOLOGY PARAMETERS

型号 MODEL	载重量 (kg) CAPACITY (kg)	速度 (m/s) SPEED (m/s)	轿厢净尺寸 (宽×深×高, mm) NET CAR SIZE (CW×CD×CH,mm)	净开门 (宽×高, mm) NET DOOR OPEN (HW×HD,mm)	井道净尺寸 (宽×深, mm) NET SHAFT SIZE (OP×OPH,mm)	高度OH (mm) OVERHEAD (mm)	底坑深度PD (mm) PIT DEPTH (mm)	额定功率 (KW) RATED POWER (kW)
LTHX9000	9000	0.5	3000X5000X2200	中分四扇2800X2100	4900X5600	4700	2000	31.2
LTHX10500	10500	0.5	3000X5800X2200	中分四扇2800X2100	4900X6500	4700	2000	36.4
LTHX11000	11000	0.5	3000X6100X2200	中分四扇2800X2100	4900X6800	4700	2000	41.6

注: 此图仅供选型时参考, 如须施工用图, 请以井道图册或技术部设计为准!

Note: This Table Is For Your Convenience To Choose the Product Only. For actual construction, please refer to the well drawing or the design of the technology department.

CONSTRUCTION LAYOUT

小机房载货电梯土建布置图

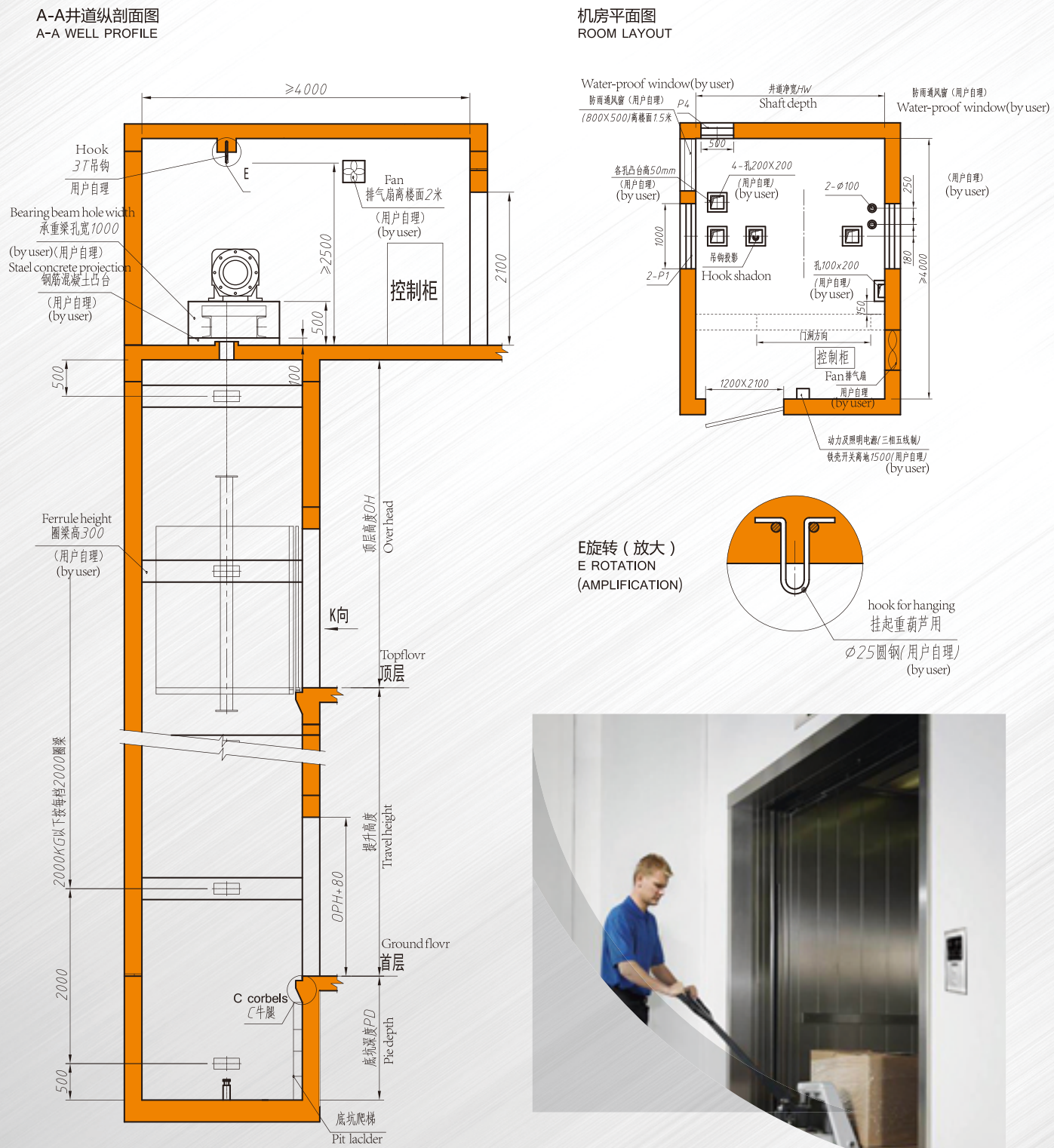

井道平面图
BOTTOM PLANE GRAPH

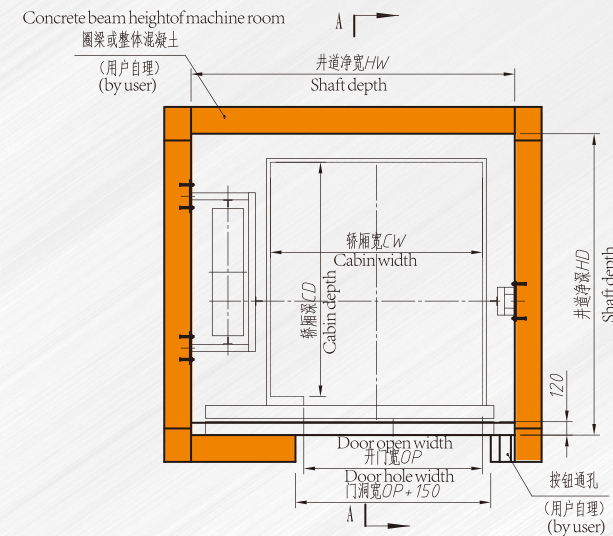

底坑平面图
PIT FLOOR PLAN

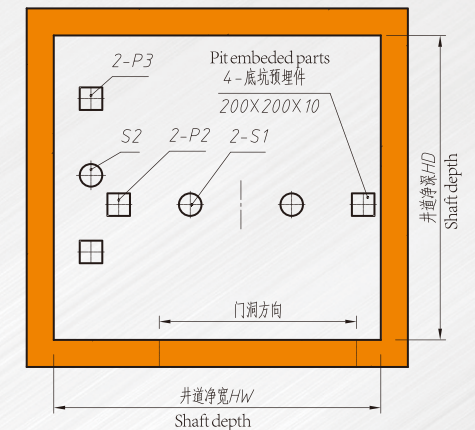

K向厅门立面图
K TO THE HALL DOOR ELEVATION

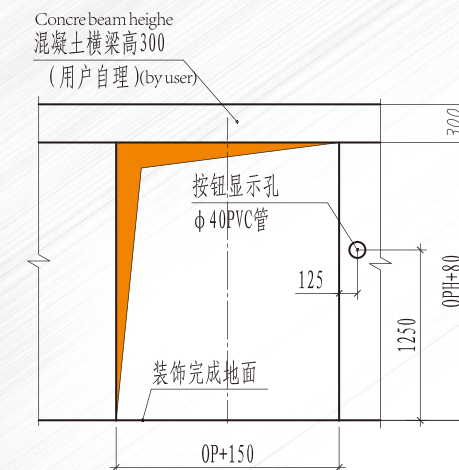

E牛腿 (放大)
E CORBELS (AMPLIFICATION)

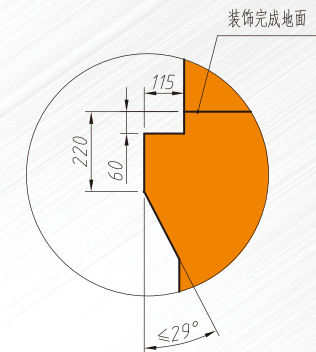

WIN1000-III 系列载货电梯技术参数 (2:1永磁同步)
WIN1000-III FREIGHT ELEVATOR TECHNOLOGY PARAMETERS

型号 MODEL	载重量 (kg) CAPACITY (kg)	速度 (m/s) SPEED (m/s)	轿厢净尺寸 (宽×深×高, mm) NET CAR SIZE (CW×CD×CH,mm)	井道净尺寸 (宽×深, mm) NET OPENING (OP×OPH,mm)	净开门 (宽×高, mm) NET WELL SIZE (HW×HD,mm)	高度OH (mm) OH (mm)	底坑深度PD (mm) PD (mm)	额定功率 (KW) RATED POWER (kW)
LTH1000	1000	1.0/1.6/1.75	1400×1600×2200	2300×2200	旁开1200×2100	4300/4400/4500	1500/1600/1700	6.8/10.9/13.6
LTH1600	1600	1.0/1.6/1.75	1700×2000×2200	2800×2600	旁开1500×2100	4300/4400/4500	1500/1600/1700	10.9/17.3/19
LTH2000	2000	1.0/1.6/1.75	1900×2100×2200	2900×2700	旁开1600×2100	4300/4400/4500	1500/1600/1700	13.6/21.8/23.8

注：此图仅供选型时参考，如须施工用图，请以井道图册或技术部设计为准！
Note: This Table Is For Your Convenience To Choose the Product Only. For actual Construction, Please Refer To The Well Drawing Or The Design Of The Technology Department.

CONSTRUCTION LAYOUT

无机房载货电梯土建布置图

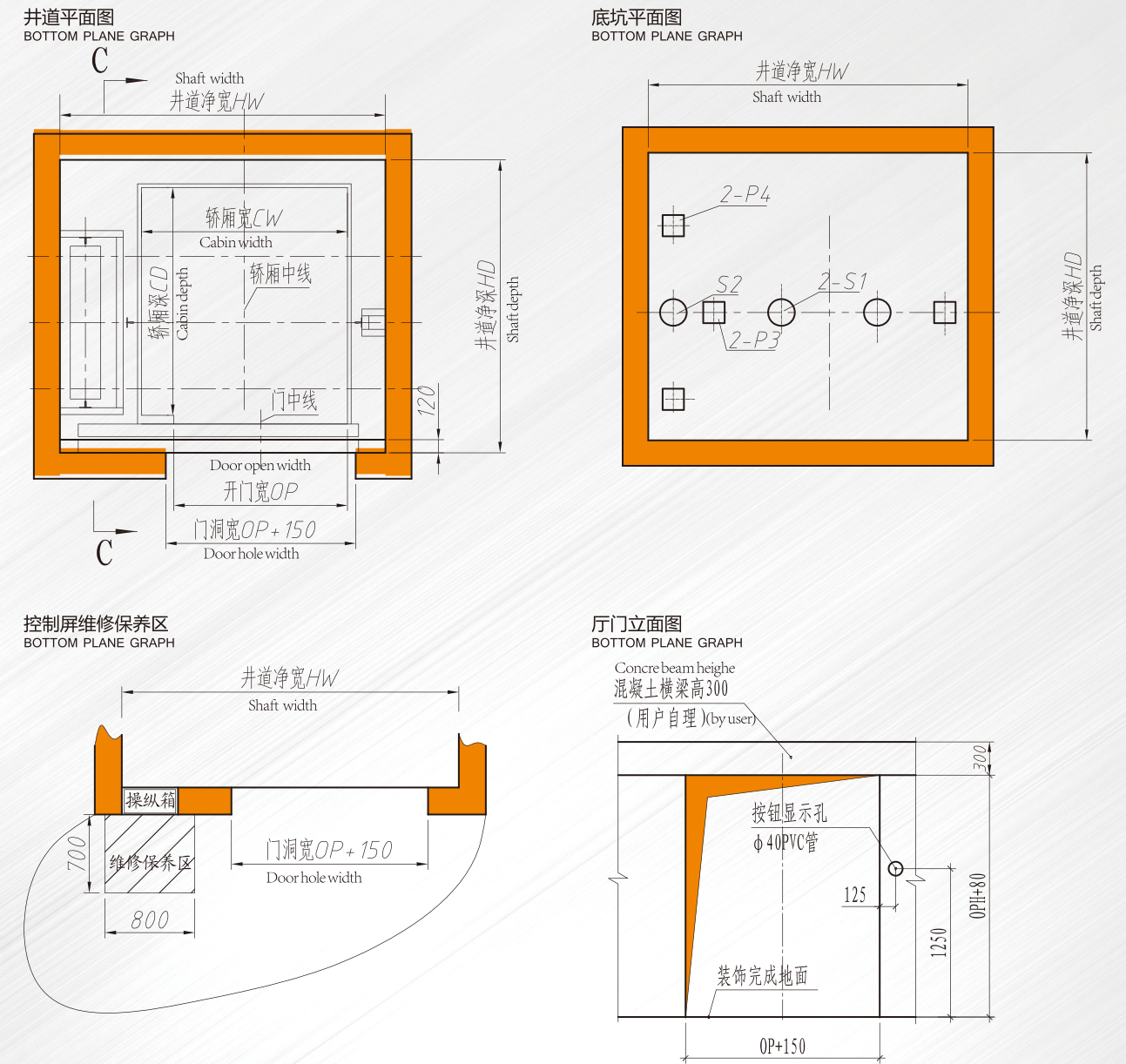
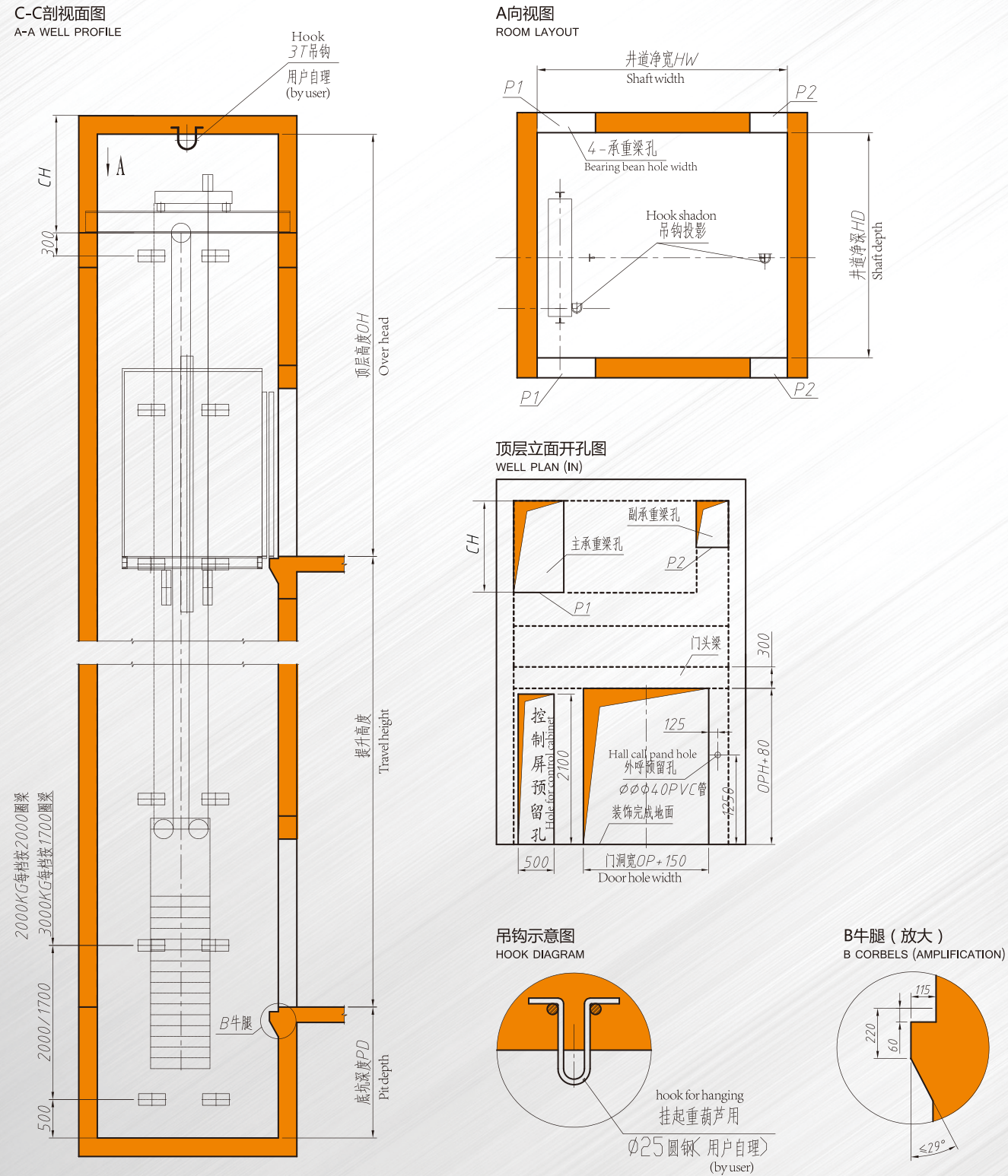

WIN1000-IV 无机房载货电梯技术参数 (永磁同步)

WIN1000-IV FREIGHT ELEVATOR TECHNOLOGY PARAMETERS

型号 MODEL	载重量 (kg) CAPACITY (kg)	速度 (m/s) SPEED (m/s)	轿厢净尺寸 (宽×深×高, mm) NET CAR SIZE (CW×CD×CH, mm)	井道净尺寸 (宽×深, mm) NET OPENING (OP×OPH, mm)	净开门 (宽×高, mm) NET WELL SIZE (HW×HD, mm)	高度OH (mm) OH (mm)	底坑深度PD (mm) PD (mm)	曳引比 ROPING
LTHW2000	2000	0.5/0.75/1.0	1900×2100×2200	3000×2700	旁开1600×2100	4700 (CH=1280)	1500	4: 1
LTHW3000	3000	0.5/0.75/1.0	2200×2500×2200	3500×3200	旁开1700×2100	4800 (CH=1440)	1600	4: 1
LTHW4800	4800	0.5	2600×3200×2200	4400×4000	中分四扇2400×2100	5300 (CH=1820)	1800	6: 1

注：此图仅供选型时参考，如须施工用图，请以井道图册或技术部设计为准！
Note: This Table Is For Your Convenience To Choose the Product Only. For actual construction, please refer to the well drawing or the design of the technology department.



懂服务，更懂您

SERVE YOUR NEED ,KNOW YOU MORE

从研发、设计到生产，从售前、售中到售后，菱王将一体化服务理念贯彻到每一个细节，为客户带来贴心的、周到的服务感受。我们不仅专注于最佳的电梯解决方案，更关注客户的内心与喜好，因为菱王深知，只有懂您才能做得更好！

Winone runs through its integrative service to every detail, from R&D, design to production, from pre-sales, under-sales to after-sales service. These will bring customers considerate and thoughtful service. We are not only focus on the best solution on elevator, but also the feedbacks and prefers from customers. We deeply believe that the more we understand you the better we will be.

